

WBS NO: 2026CPT.01.15.20581, ETC.

CONTRACT: DA00666

**STATE OF NORTH CAROLINA
DIVISION OF HIGHWAYS
MARTIN**

STATE	STATE PROJECT REFERENCE NUMBER	SHEET NO.
NC	2026CPT.01.15.20581, ETC.	1
STATE PROJECT NUMBER		DESCRIPTION
2026CPT.01.15.20581		P.E., CONST.
2026CPT.01.15.20582		P.E., CONST.

TYPE OF WORK: MILLING & RESURFACING

MAP	ROUTE	FROM	TO
01	SR 1116 (Rodgers School Rd.)	SR 1117 (White Rd.)	US 17
02	RES School Bus Driveway	SR 1116 (Rodgers School Rd.)	SR 1116 (Rodgers School Rd.)
05	SR 1500 (Holly Springs Church Rd.)	SR 1595 (Jones Rd.)	US 64
06	SR 1516 (Fire Dept. Road)	SR 1114 (Grand Canyon Rd.)	SR 1535 (Hollow Pond Rd.)
07	Griffins Township Fire Dept.	SR 1516 (Fire Dept. Rd.)	Concrete Pavement
08	SR 1521 (Mill Inn Rd.)	SR 1516 (Kader Lilley Rd.)	US 17
09	SR 1541 (Dymond City Rd.)	SR 1538 (E.H. Williams Rd.)	NC 171
10	SR 1117 (Green Acres Rd.)	SR SR 1114 (Dan Peele Rd.)	SR 1115 (White Rd.)
11	SR 1120 (Hickory Grove Rd.)	SR 1117 (Bear Trap Rd.)	SR 1119 (Ralph Taylor Rd.)
14	SR 1540 (Sim Daniel Rd.)	SR 1539 (Evan Perry Rd.)	NC 171
15	SR 1601 (Brezze Woods Ave.)	SR 1501 (Big Mill Rd.)	CDS

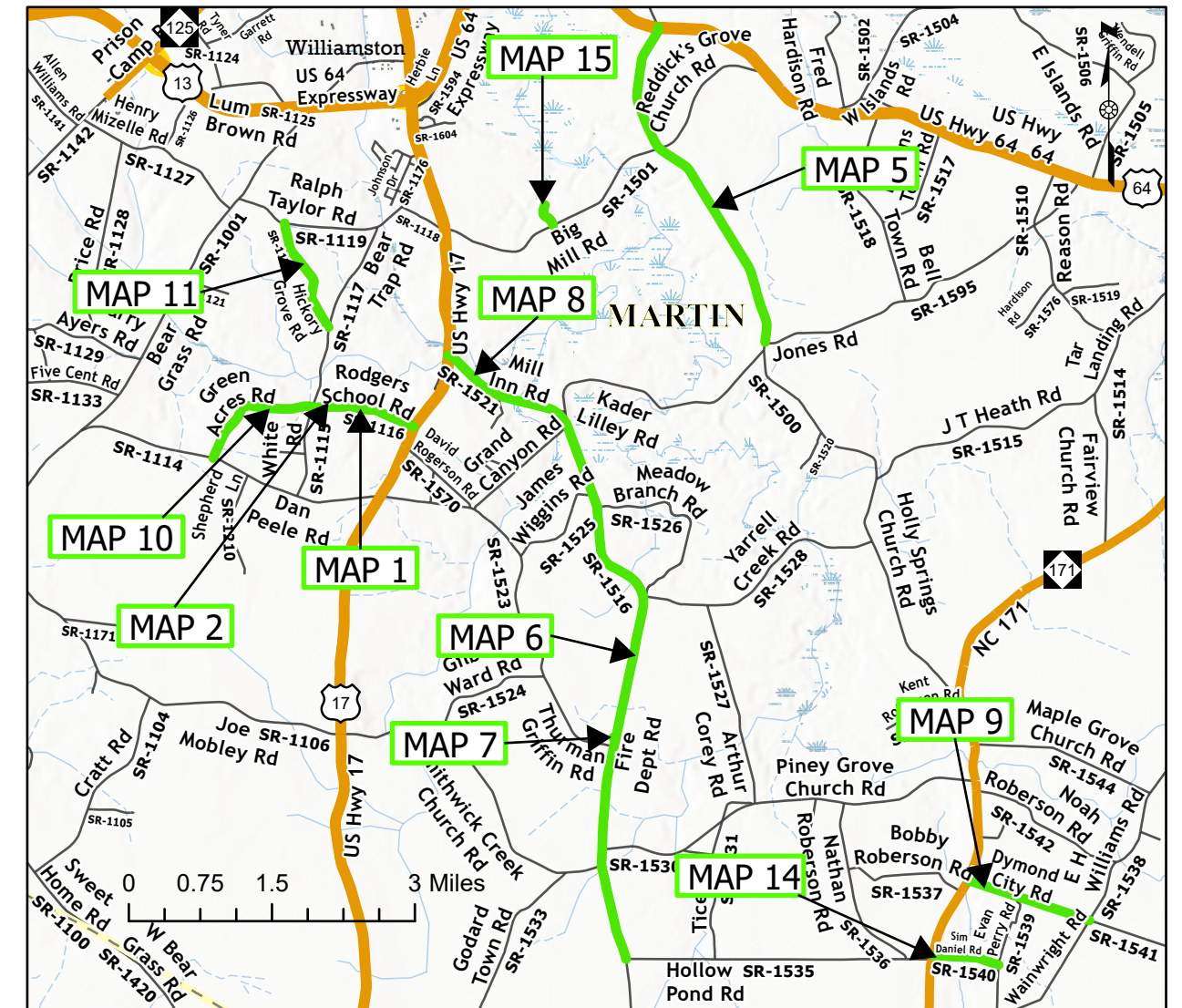

PROJECT LENGTH

MAP	MILES	MAP	MILES	MAP	MILES
01	0.904	07	0.02	11	0.99
02	0.07	08	1.229	14	0.57
05	3.05	09	1.09	15	0.21
06	4.789	10	1.1		

Prepared in the Office of:
DIVISION OF HIGHWAYS
113 AIRPORT DR., EDENTON, NC 27932

B. N. BRASWELL, PE
DIV. PROJ. DEVELOPMENT ENGINEER

M. S. WINSLOW
DIVISION CONTRACT ENGINEER

D. J. CLODGO, PE, PMP
DIVISION PROJECT TEAM LEAD

D. H. STALLINGS
DIVISION DESIGN ENGINEER



WBS NO: 2026CPT.01.15.20581, ETC.

CONTRACT: DA00666

**STATE OF NORTH CAROLINA
DIVISION OF HIGHWAYS**

MARTIN

TYPE OF WORK: MILLING & RESURFACING

STATE	STATE PROJECT REFERENCE NUMBER	SHEET NO.
NC	2026CPT.01.15.20581, ETC.	2
STATE PROJECT NUMBER		DESCRIPTION
2026CPT.01.15.20581		P.E., CONST.

MAP	ROUTE	FROM	TO
03	SR 1162 (Jones St.)	SR 1160 (Roberson St.)	SR 1164 (Main St.)
04	SR 1164 (Main St.)	Pitt County Line	SR 1303 (Dixon Rd.)

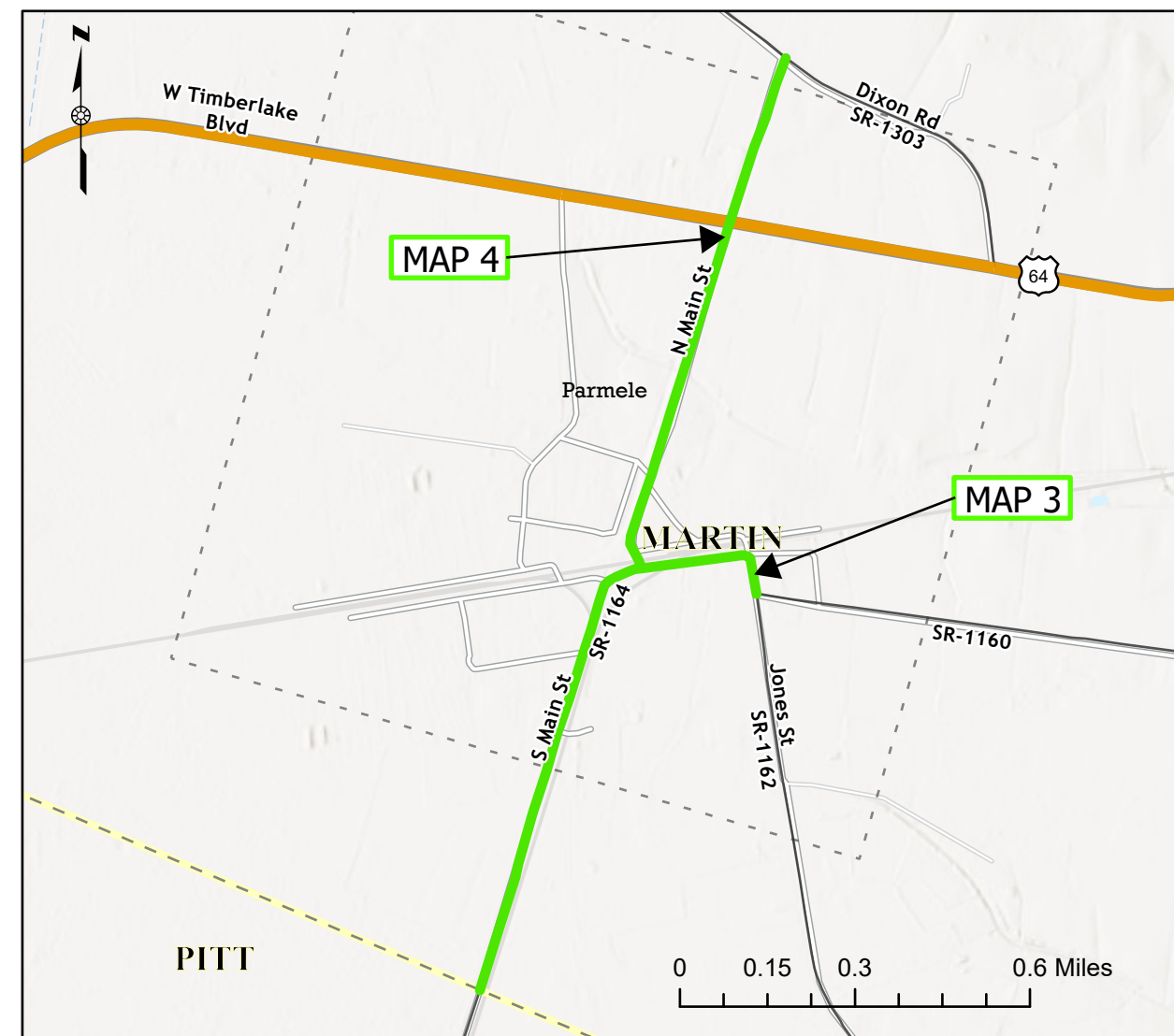

PROJECT LENGTH

MAP	MILES
03	0.21
04	1.39

Prepared in the Office of:
DIVISION OF HIGHWAYS
113 AIRPORT DR., EDENTON, NC 27932

B. N. BRASWELL, PE
DIV. PROJ. DEVELOPMENT ENGINEER

M. S. WINSLOW
DIVISION CONTRACT ENGINEER

D. J. CLODGO, PE, PMP
DIVISION PROJECT TEAM LEAD

D. H. STALLINGS
DIVISION DESIGN ENGINEER



WBS NO: 2026CPT.01.15.20581, ETC.

CONTRACT: DA00666

STATE OF NORTH CAROLINA
DIVISION OF HIGHWAYS

MARTIN

TYPE OF WORK: *MILLING & RESURFACING*

STATE	STATE PROJECT REFERENCE NUMBER	SHEET NO.
NC	2026CPT.01.15.20581, ETC.	3
STATE PROJECT NUMBER		DESCRIPTION
2026CPT.01.15.20582		P.E., CONST.

MAP	ROUTE	FROM	TO
12	SR 1189 (Rawls Rd.)	SR 1159 (Third St.)	US 64 Alt

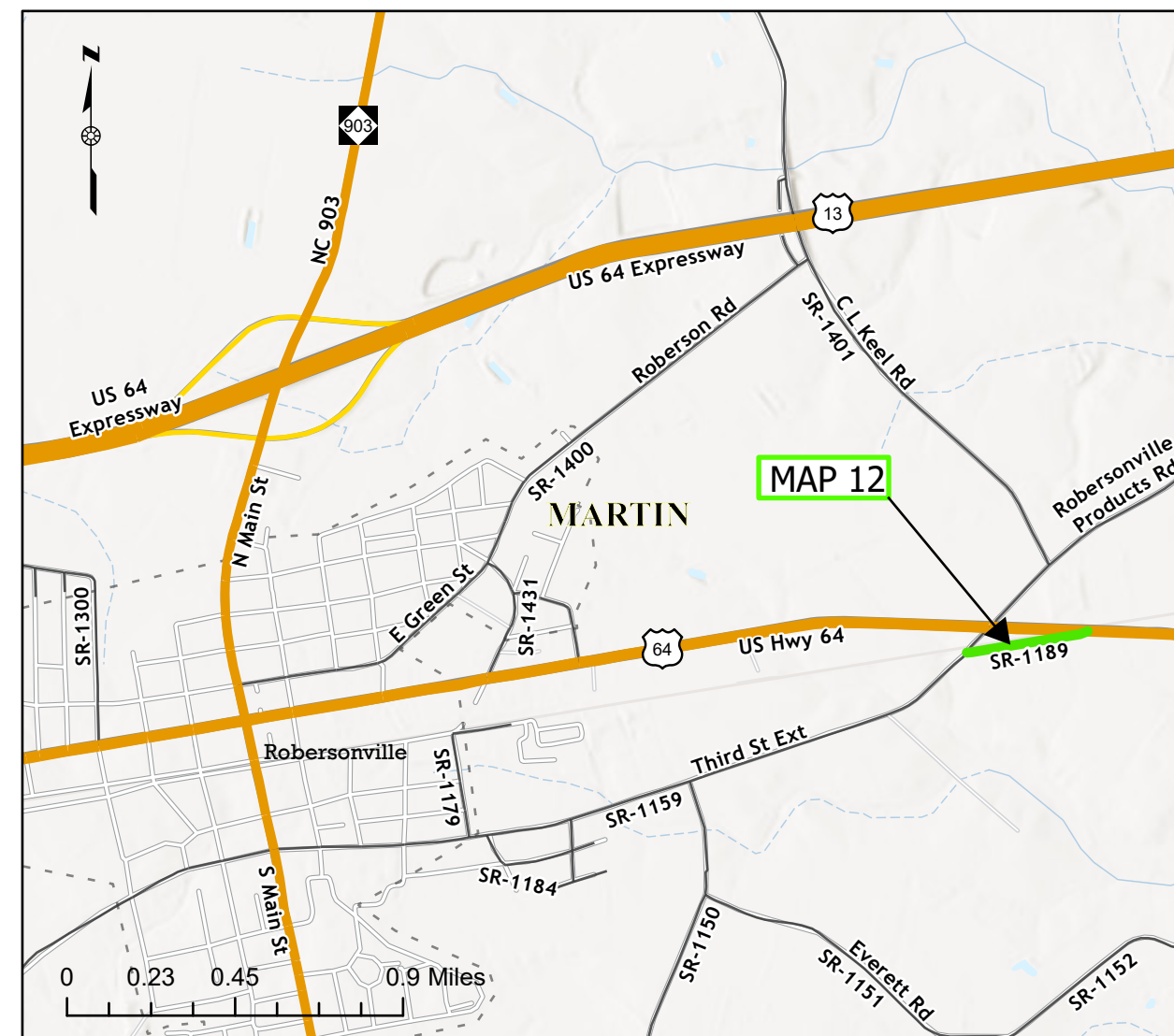

PROJECT LENGTH

MAP	MILES
12	0.27

Prepared in the Office of:
DIVISION OF HIGHWAYS
113 AIRPORT DR., EDENTON, NC 27932

B. N. BRASWELL, PE
DIV. PROJ. DEVELOPMENT ENGINEER

M. S. WINSLOW
DIVISION CONTRACT ENGINEER

D. J. CLODGO, PE, PMP
DIVISION PROJECT TEAM LEAD

D. H. STALLINGS
DIVISION DESIGN ENGINEER



WBS NO: 2026CPT.01.15.20581, ETC.

CONTRACT: DA00666

**STATE OF NORTH CAROLINA
DIVISION OF HIGHWAYS**

MARTIN

TYPE OF WORK: MILLING & RESURFACING

STATE	STATE PROJECT REFERENCE NUMBER	SHEET NO.
NC	2026CPT.01.15.20581, ETC.	4
STATE PROJECT NUMBER		DESCRIPTION
2026CPT.01.15.20582		P.E., CONST.

MAP	ROUTE	FROM	TO
13	SR 1321 (Hines Rd.)	NC 125	SR 1002 (Hassel Rd.)

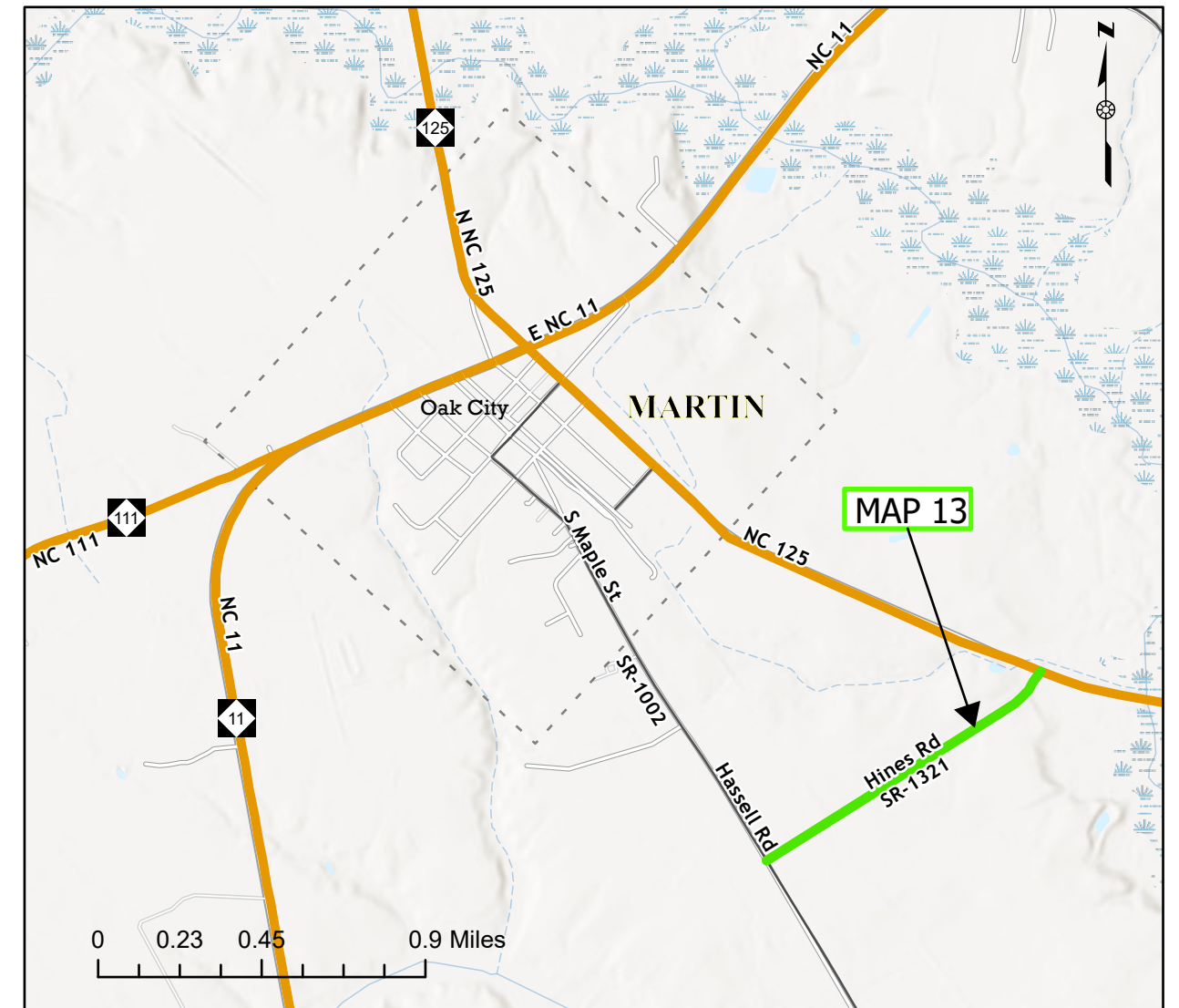

PROJECT LENGTH

MAP	MILES
13	0.75

Prepared in the Office of:
DIVISION OF HIGHWAYS
113 AIRPORT DR., EDENTON, NC 27932

B. N. BRASWELL, PE
DIV. PROJ. DEVELOPMENT ENGINEER

M. S. WINSLOW
DIVISION CONTRACT ENGINEER

D. J. CLODGO, PE, PMP
DIVISION PROJECT TEAM LEAD

D. H. STALLINGS
DIVISION DESIGN ENGINEER



PAVEMENT SCHEDULE

C1	PROP. APPROX. 1.5" ASPHALT CONCRETE SURFACE COURSE, TYPE S9.5B, AT AN AVERAGE RATE OF 165 LBS. PER SQ. YD.
V1	INCIDENTAL MILLING
U	EXISTING PAVEMENT
T	SHOULDER RECONSTRUCTION

PROJECT REFERENCE NO. 2026CPT.01.15.20581, ETC.	SHEET NO. 5
--	----------------

NOTES:

- * ALL INTERSECTING ROADS ARE TO BE RESURFACED TO THE ENDS OF THEIR RADII, THE MAIN LINE RIGHT OF WAY OR AS DIRECTED BY THE ENGINEER. THIS SHALL INCLUDE ANY TAPERS AND TURN LANES LOCATED BOTH ON THE MAIN LINE OR INTERSECTING PAVED ROADWAY.
- * EDGES, PAVEMENT WIDENING, INTERSECTIONS AND BRIDGE FLARES ARE INCLUDED IN THE SUMMARY OF QUANTITIES.
- * 1.5" OF S9.5B TO BE APPLIED THE FULL WIDTH OF THE ROADWAY
- * CONTRACTOR SHALL PERFORM PATCHING EXISTING PAVEMENT, FULL DEPTH BEFORE APPLICATION OF 1.5" OF S9.5B ON MAPS 1, 4, 6, & 9 ONLY
- * INCIDENTAL MILLING IS TO BE PERFORMED ON MAPS 3, 4, & 6
- * SHOULDER WEDGE SHALL BE USED ON ALL ROADS 22' OR WIDER, OR AS DIRECTED BY THE ENGINEER

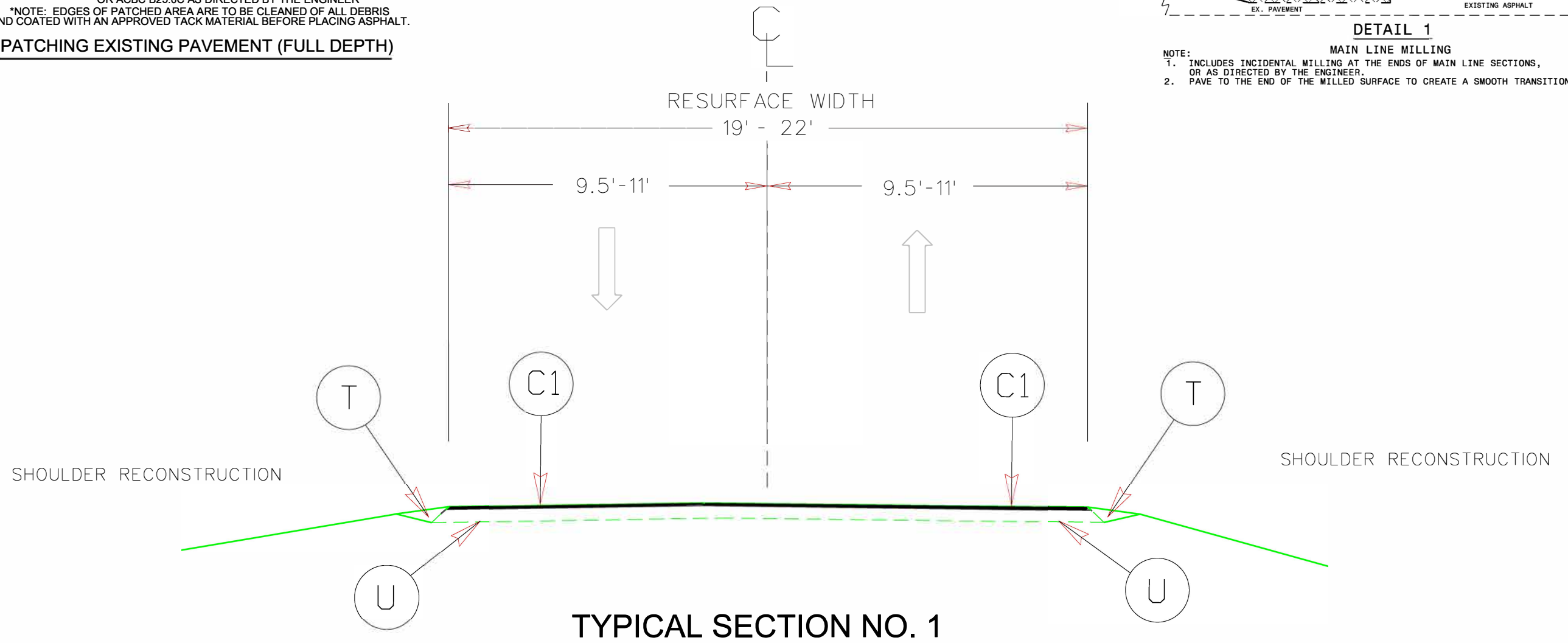
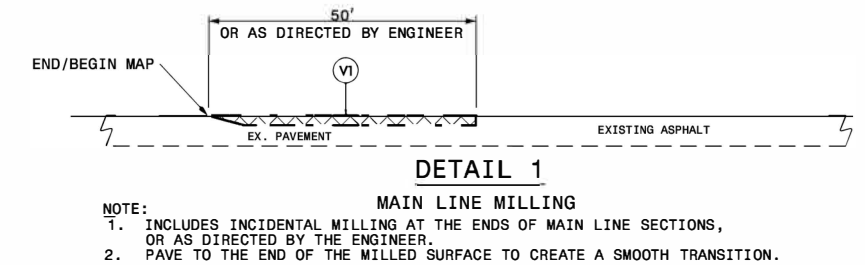
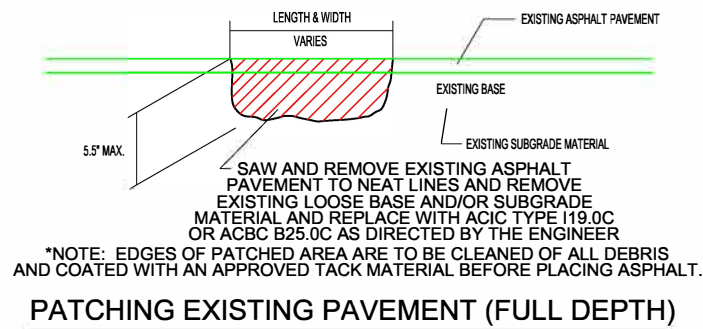

USE WITH MAPS 1, 3, 4, 6, 8, & 9

NTS

SYSTEMS
 TIME
 11/15/2025 10:00 AM
 USER: NMM

PAVEMENT SCHEDULE

C1	PROP. APPROX. 1.50" ASPHALT CONCRETE SURFACE COURSE, TYPE S9.5B, AT AN AVERAGE RATE OF 165 LBS. PER SQ. YD.
V1	INCIDENTAL MILLING
V2	MILLING ASPHALT PAVEMENT, 1.5" DEPTH
U	EXISTING PAVEMENT

PROJECT REFERENCE NO.	SHEET NO.
2026CPT.01.15.20581, ETC.	6

NOTES:

- * ALL INTERSECTING ROADS ARE TO BE RESURFACED TO THE ENDS OF THEIR RADII, THE MAIN LINE RIGHT OF WAY OR AS DIRECTED BY THE ENGINEER. THIS SHALL INCLUDE ANY TAPERS AND TURN LANES LOCATED BOTH ON THE MAIN LINE OR INTERSECTING PAVED ROADWAY.
- * EDGES, PAVEMENT WIDENING, INTERSECTIONS AND BRIDGE FLARES ARE INCLUDED IN THE SUMMARY OF QUANTITIES.
- * 1.5" OF S9.5B TO BE APPLIED THE FULL WIDTH OF THE ROADWAY
- * SHOULDER WEDGE SHALL BE USED ON ALL ROADS 22' OR WIDER, OR AS DIRECTED BY THE ENGINEER
- * INCIDENTAL MILLING IS TO BE PERFORMED ON MAP 5 ONLY
- * CONTRACTOR SHALL PERFORM PATCHING EXISTING PAVEMENT, FULL DEPTH BEFORE APPLICATION OF 1.5" OF S9.5B ON MAPS 5 & 7 ONLY
- * MAP 2 IS A 20' WIDE SCHOOL BUS DRIVEWAY LOOP
- * MAP 7 IS AN 80' WIDE FIRE DEPARTMENT DRIVEWAY

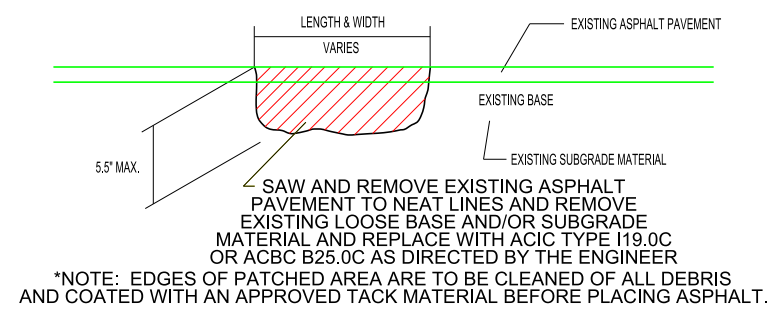

SAW AND REMOVE EXISTING ASPHALT PAVEMENT TO NEAT LINES AND REMOVE EXISTING LOOSE BASE AND/OR SUBGRADE MATERIAL AND REPLACE WITH AC1C TYPE I19.0C OR ACBC B25.0C AS DIRECTED BY THE ENGINEER

*NOTE: EDGES OF PATCHED AREA ARE TO BE CLEANED OF ALL DEBRIS AND COATED WITH AN APPROVED TACK MATERIAL BEFORE PLACING ASPHALT.

PATCHING EXISTING PAVEMENT (FULL DEPTH)

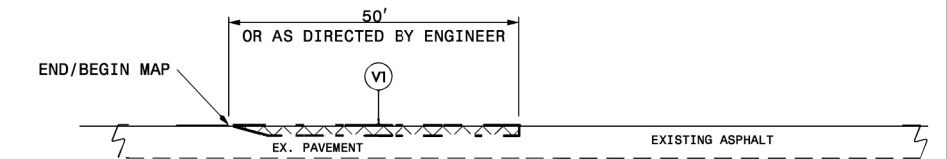

DETAIL 1

MAIN LINE MILLING

- NOTE:
1. INCLUDES INCIDENTAL MILLING AT THE ENDS OF MAIN LINE SECTIONS, OR AS DIRECTED BY THE ENGINEER.
 2. PAVE TO THE END OF THE MILLED SURFACE TO CREATE A SMOOTH TRANSITION.

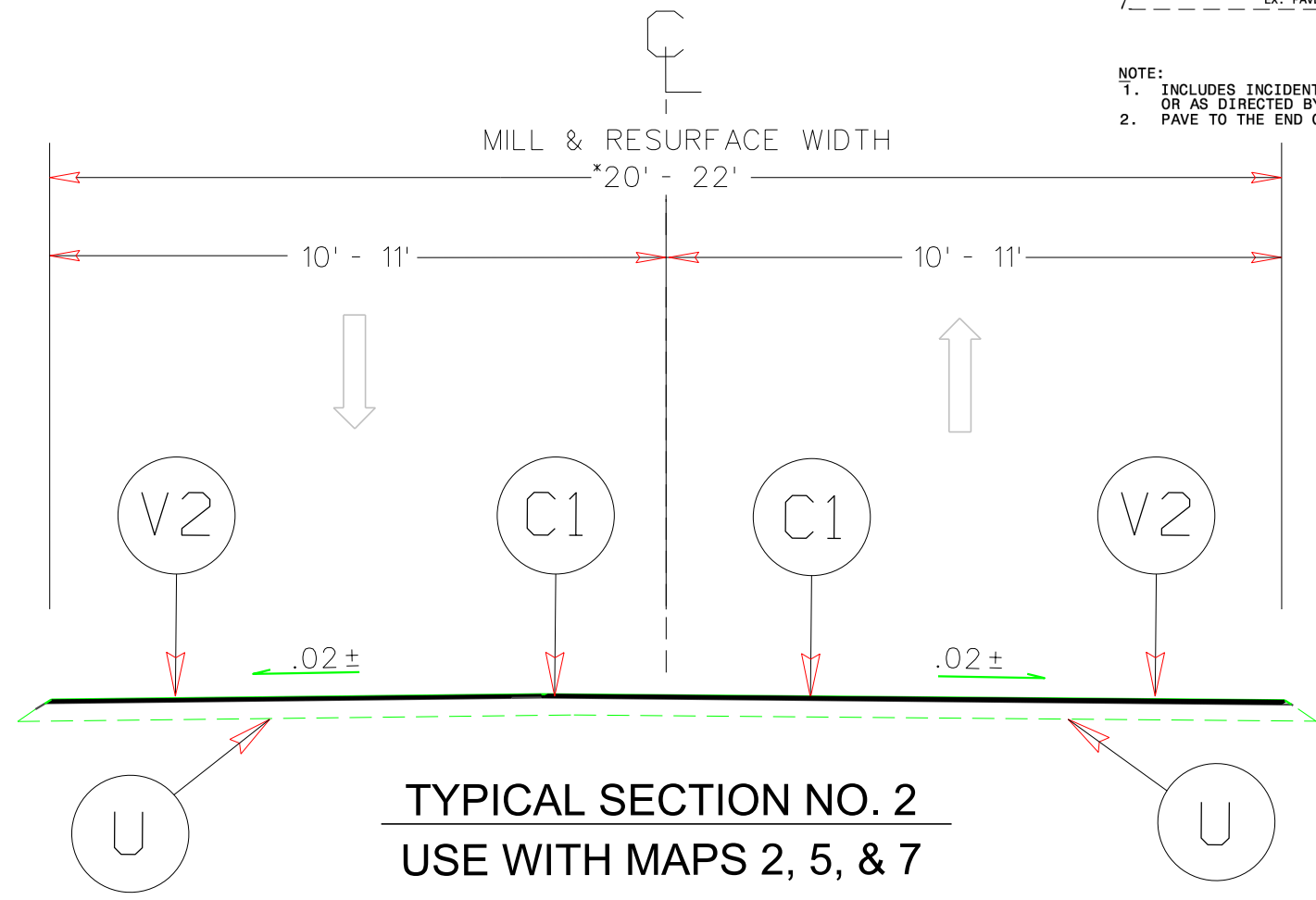

TYPICAL SECTION NO. 2
USE WITH MAPS 2, 5, & 7

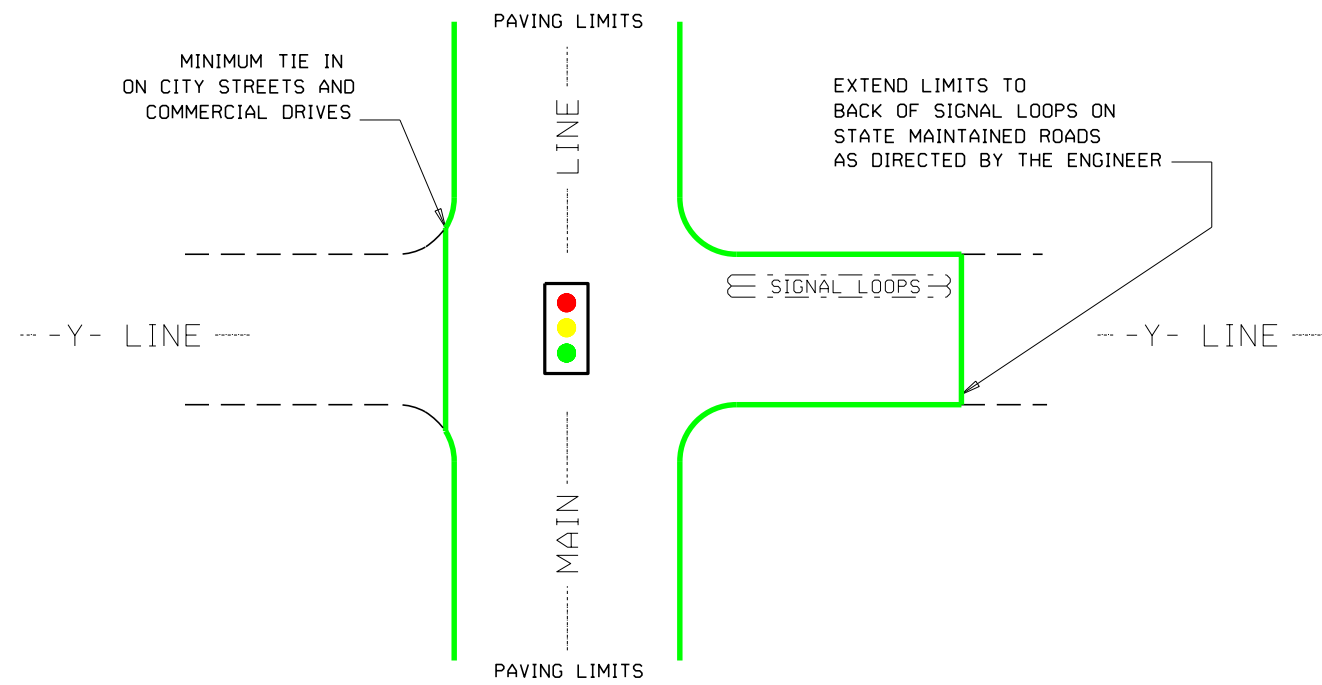

TYPICAL DETAIL OF PROJECT LIMITS AT SIGNALIZED Y LINES

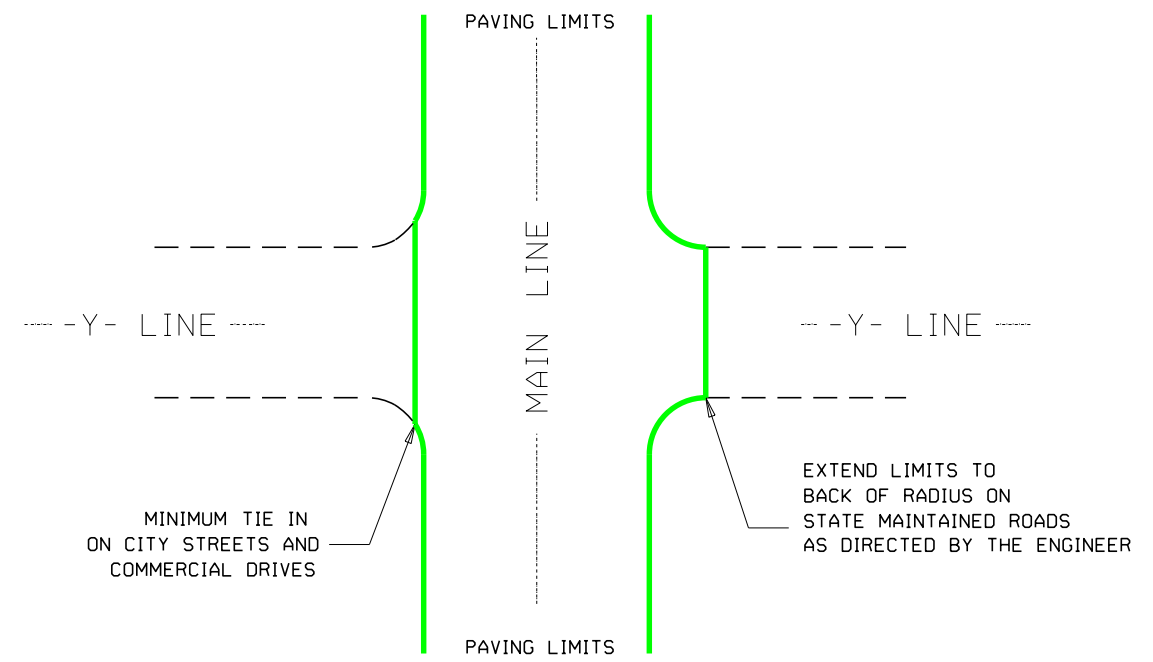

TYPICAL DETAIL OF PROJECT LIMITS AT UNSIGNALIZED Y LINES

ADDITIONAL INTERSECTIONS (NON-TYPICAL)

Extend paving limits to back of radius or loop on the following intersections:

MAP#	STREET NAME	COMMENTS
	PAVE ALL STATE OWNED & TOWN STREETS TO BACK OF RADIUS FOR THIS PROJECT	

PROJECT NO.	SHEET NO.	TOTAL NO.
2026CPT.01.15.20581, ETC.	9	

SUMMARY OF QUANTITIES

PROJECT NO	COUNTY	MAP NO	ROUTE	DESCRIPTION	TYP NO	LANES	LANE TYPE	LENGTH	WIDTH	BEG N	END MP	0000100000-N	0106000000-E	1220000000-E	1245000000-E	1260000000-E	1297000000-E	1330000000-E	1519000000-E	1520000000-E	1575000000-E	1705000000-E	6084000000-E	6117000000-N			
												MOBILIZATION	BORROW EXCAVATION	INCIDENTAL STONE BASE	SHOULDER RECONSTRUCTION	AGGREGATE SHOULDER BORROW	MILLING ASPHALT PAVEMENT, **** DEPTH (1-1/2")	INCIDENTAL MILLING	ASPHALT CONC SURFACE COURSE, S9.5B	ASPHALT CONC LEVELING COURSE, S9.5B	ASPHALT BINDER FOR PLANT MIX	PATCHING EXISTING PAVEMENT (FULL DEPTH)	SEEDING & MULCHING	RESPONSE FOR EROSION CONTROL			
												LS	CY	TON	SMI	TON	SY	SY	TON	TON	TON	TON	ACR	EA			
2026CPT.01.15.20581	Martin	1	SR-1116 / RODGERS SCHOOL RD	FROM SR 1115 (WHITE RD) TO US 17	1	2	2WU	0.904	20	0.000	0.904	1	163	14	1.81	12			962		63	2	0.9	1			
2026CPT.01.15.20581	Martin	2	RES SCHOOL BUS DRIVEWAY	FROM SR 1116 (RODGERS SCHOOL RD.) TO SR 1116 (RODGERS SCHOOL RD.)	2	2	2WU	0.070	20	0.000	0.070	*		4			1,049		87		6						
2026CPT.01.15.20581	Martin	3	SR-1162 / JONES ST	FROM 1160 (JONES ST) TO SR 1164 (MAIN ST)	1	2	2WU	0.210	19	2.210	2.420	*	38	3	0.42	12		315	233		15			0.2			
2026CPT.01.15.20581	Martin	4	SR-1164 / N MAIN ST	FROM PITT COUNT LONE TO SR 1303 (DIXON RD)		2	2WU	1.390	22	0.000	1.390	*	250	3	2.78	16		1,062	1,568	3	103	16		1.3			
2026CPT.01.15.20581	Martin	5	SR-1500 / HOLLY SPRINGS CHURCH RD	FROM SR 1595 (JONES RD) TO US 64	2	2	2WU	3.050	22	0.900	3.950	*		30			39,365	1,031	3,519	10	230	15					
2026CPT.01.15.20581	Martin	6	SR-1516 / FIRE DEPT RD	FROM SR 1516 (GRAND CANYON RD) TO SR 1535 (HOLLOW POND RD)	1	2	2WU	4.789	21	2.310	7.099	*	862	92	9.58	24		14	5,348		348	15		9.3	1		
2026CPT.01.15.20581	Martin	7	GRIFFINS TOWNSHIP FIRE DEPT.	FROM SR 1516 (FIRE DEPT. RD.) TO CONCRETE PAVEMENT	2	2	MU	0.020	80	0.000	0.020	*					910		75		6	27					
2026CPT.01.15.20581	Martin	8	SR-1521 / MILL INN RD	FROM SR 1516 (FIRE DEPT. ROAD) TO US 17	1	2	2WU	1.229	21	0.000	1.229	*	221	20	2.46	6			1,426	3	93			1.2			
2026CPT.01.15.20581	Martin	9	SR-1541 / DYMOND CITY RD	FROM SR 1538 (E.H. WILLIAMS RD) TO NC 171	1	2	2WU	1.090	20	0.000	1.090	*	196	11	2.18	6			1,329		95	170		1.1			
TOTAL FOR PROJ NO. 2026CPT.01.15.20581																											
								12.752				*	1,730	177	19.23	76		41,324	2,422	14,547	16	959	245	14.0	2		
2026CPT.01.15.20582	Martin	10	SR-1117 / GREEN ACRES RD	FROM SR 1114 (DAN PEELE RD) TO SR 1115 (WHITE RD.)	3	2	2WU	1.100	20	0.000	1.100	*		12					937		61						
2026CPT.01.15.20582	Martin	11	SR-1120 / HICKORY GROVE RD	FROM SR 1117 (BEAR TRAP RD) TO SR 1119 (RAPH TAYLOR RD)	3	2	2WU	0.990	19	0.000	0.990	*		15					801		52						
2026CPT.01.15.20582	Martin	12	SR-1189 / RAWLS RD	FROM SR 1159 (THIRD ST) TO US 64 ALT	3	2	2WU	0.270	21	0.000	0.270	*		2					241		16						
2026CPT.01.15.20582	Martin	13	SR-1321 / HINES RD	FROM NC 125 TO SR 1002 (HASSEL RD)	3	2	2WU	0.750	20	0.000	0.750	*		9					639		42						
2026CPT.01.15.20582	Martin	14	SR-1540 / SIM DANIEL RD	FROM NC 171 TO SR 1539 (EVAN PERRY RD)	3	2	2WU	0.570	21	0.000	0.570	*		6			598		509		33						
2026CPT.01.15.20582	Martin	15	SR-1601 / BREEZE WOODS AVE	FROM SR 1501 (BIG MILL RD) TO CDS	3	2	2WU	0.210	19	0.000	0.210	*		2					199		13						
TOTAL FOR PROJ NO. 2026CPT.01.15.20582																											
								3.890				*		46				598	3,326		217						
GRAND TOTAL								16.642				1	1,730	223	19.23	76		41,324	3,020	17,873	16	1,176	245	14.0	2		

PROJECT NO.	SHEET NO.	TOTAL NO.
2026CPT.01.15.20581, ETC.	10	

THERMOPLASTIC AND PAINT QUANTITIES

PROJECT NO	COUNTY	MAP NO	ROUTE	DESCRIPTION	TYP NO	LANES	LANE TYPE	LENGTH	WIDTH	BEGIN MP	END MP	441300000-E	445700000-N	470900000-E	472000000-E		481000000-E					
												WORK ZONE ADVANCE/GENERAL WARNING SIGNING	TEMPORARY TRAFFIC CONTROL (SP)	THERMO PAVEMENT MARKING LINES (24" 90 MILS) (SP)	THERMOPLASTIC PAVEMENT MARKING CHARACTER (90 MILS), SCHOOL	THERMOPLASTIC PAVEMENT MARKING CHARACTER (90 MILS), RXR	PAINT PAVEMENT MARKING LINES (4") YELLOW	PAINT PAVEMENT MARKING LINES (4") WHITE				
												SF	LS	LF	EA	EA	LF	LF				
							MI	FT														
2026CPT.01.15.20581	Martin	1	SR-1116 / RODGERS SCHOOL RD	FROM SR 1116 (WHITE RD) TO US 17	1	2	2WU	0.904	20	0	0.904	112	1	74	12	EA		5,966	9,546			
2026CPT.01.15.20581	Martin	2	RES SCHOOL BUS DRIVEWAY	FROM SR 1116 (RODGERS SCHOOL RD.) TO SR 1116 (RODGERS SCHOOL RD.)	2	2	2WU	0.07	20	0	0.07		*									
2026CPT.01.15.20581	Martin	3	SR-1162 / JONES ST	FROM 1160 (JONES ST) TO SR 1164 (MAIN ST)	1	2	2WU	0.21	19	2.21	2.42		*	107		8	1,386	2,218				
2026CPT.01.15.20581	Martin	4	SR-1164 / N MAIN ST	FROM PITT COUNT LONE TO SR 1303 (DIXON RD)	1	2	2WU	1.39	22	0	1.39		*	108		8	9,174	14,678				
2026CPT.01.15.20581	Martin	5	SR-1500 / HOLLY SPRINGS CHURCH RD	FROM SR 1595 (JONES RD) TO US 64	2	2	2WU	3.05	22	0.9	3.95	256	*	57			20,130	32,208				
2026CPT.01.15.20581	Martin	6	SR-1516 / FIRE DEPT RD	FROM SR 1516 (GRAND CANYON RD) TO SR 1535 (HOLLOW POND RD)	1	2	2WU	4.789	21	2.31	7.099	496	*				31,614	50,582				
2026CPT.01.15.20581	Martin	7	GRIFFINS TOWNSHIP FIRE DEPT.	FROM SR 1516 (FIRE DEPT. RD.) TO CONCRETE PAVEMENT	2	2	MU	0.02	80	0	0.02		*									
2026CPT.01.15.20581	Martin	8	SR-1521 / MILL INN RD	FROM SR 1516 (FIRE DEPT. ROAD) TO US 17	1	2	2WU	1.229	21	0	1.229	88	*				8,111	12,978				
2026CPT.01.15.20581	Martin	9	SR-1541 / DYMOND CITY RD	FROM SR 1538 (E.H. WILLIAMS RD) TO NC 171	1	2	2WU	1.09	20	0	1.09		*				7,194	11,510				
TOTAL FOR PROJ NO. 2026CPT.01.15.20581												952	*	346	12	16	83,575	133,720				
															28		217,295					
2026CPT.01.15.20582	Martin	10	SR-1117 / GREEN ACRES RD	FROM SR 1114 (DAN PEELE RD) TO SR 1115 (WHITE RD.)	3	2	2WU	1.1	20	0	1.1	112	*				7,260	11,616				
2026CPT.01.15.20582	Martin	11	SR-1120 / HICKORY GROVE RD	FROM SR 1117 (BEAR TRAP RD) TO SR 1119 (RAPH TAYLOR RD)	3	2	2WU	0.99	19	0	0.99		*				10,454	10,454				
2026CPT.01.15.20582	Martin	12	SR-1189 / RAWLS RD	FROM SR 1159 (THIRD ST) TO US 64 ALT	3	2	2WU	0.27	21	0	0.27		*				1,782	2,851				
2026CPT.01.15.20582	Martin	13	SR-1321 / HINES RD	FROM NC 125 TO SR 1002 (HASSEL RD)	3	2	2WU	0.75	20	0	0.75		*				4,950	7,920				
2026CPT.01.15.20582	Martin	14	SR-1540 / SIM DANIEL RD	FROM NC 171 TO SR 1539 (EVAN PERRY RD)	3	2	2WU	0.57	21	0	0.57		*				3,762	6,019				
2026CPT.01.15.20582	Martin	15	SR-1601 / BREEZE WOODS AVE	FROM SR 1501 (BIG MILL RD) TO CDS	3	2	2WU	0.21	19	0	0.21		*				28,208	38,860				
TOTAL FOR PROJ NO. 2026CPT.01.15.20582												389	*				28,208	38,860				
																	67,068					
GRAND TOTAL												16,642				1,064	1	346	12	16	111,783	172,580
															28		284,363					

THERMOPLASTIC AND PAINT QUANTITIES

PROJECT NO	COUNTY	MAP NO	ROUTE	DESCRIPTION	TYP NO	LANES	LANE TYPE	LENGTH	WIDTH	BEGIN MP	END MP	483000000-E	483500000-E	484000000-N		489000000-E		470400000-E				
												PAINT PAVEMENT MARKING LINES (16")	PAINT PAVEMENT MARKING LINES (24")	PAINT PAVEMENT MARKING CHARACTER (MSG SCHOOL)	PAINT PAVEMENT MARKING CHARACTER (MSG RXR)	HOT SPRAY THERMOPLASTIC PAVEMENT MARKING LINES, (4", 65 MILS) WHITE	HOT SPRAY THERMOPLASTIC PAVEMENT MARKING LINES, (4", 65 MILS) YELLOW	THERMOPLASTIC PAVEMENT MARKING LINES (16", 90 MILS)				
												LF	LF	EA	EA	LF	LF	LF				
							MI	FT														
2026CPT.01.15.20581	Martin	1	SR-1116 / RODGERS SCHOOL RD	FROM SR 1115 (WHITE RD) TO US 17	1	2	2WU	0.904	20	0	0.904			74	12		9,546	5,966				
2026CPT.01.15.20581	Martin	2	RES SCHOOL BUS DRIVEWAY	FROM SR 1116 (RODGERS SCHOOL RD.) TO SR 1116 (RODGERS SCHOOL RD.)	2	2	2WU	0.07	20	0	0.07											
2026CPT.01.15.20581	Martin	3	SR-1162 / JONES ST	FROM 1160 (JONES ST) TO SR 1164 (MAIN ST)	1	2	2WU	0.21	19	2.21	2.42	160	107		8	2,218	1,386	160				
2026CPT.01.15.20581	Martin	4	SR-1164 / N MAIN ST	FROM PITT COUNT LONE TO SR 1303 (DIXON RD)	1	2	2WU	1.39	22	0	1.39	161	108		8	14,678	9,174	161				
2026CPT.01.15.20581	Martin	5	SR-1500 / HOLLY SPRINGS CHURCH RD	FROM SR 1595 (JONES RD) TO US 64	2	2	2WU	3.05	22	0.9	3.95	84	57			32,208	20,130	84				
2026CPT.01.15.20581	Martin	6	SR-1516 / FIRE DEPT RD	FROM SR 1516 (GRAND CANYON RD) TO SR 1535 (HOLLOW POND RD)	1	2	2WU	4.789	21	2.31	7.099					50,582	31,614					
2026CPT.01.15.20581	Martin	7	GRIFFINS TOWNSHIP FIRE DEPT.	FROM SR 1516 (FIRE DEPT. RD.) TO CONCRETE PAVEMENT	2	2	MU	0.02	80	0	0.02											
2026CPT.01.15.20581	Martin	8	SR-1521 / MILL INN RD	FROM SR 1516 (FIRE DEPT. ROAD) TO US 17	1	2	2WU	1.229	21	0	1.229					12,978	8,111					
2026CPT.01.15.20581	Martin	9	SR-1541 / DYMOND CITY RD	FROM SR 1538 (E.H. WILLIAMS RD) TO NC 171	1	2	2WU	1.09	20	0	1.09					11,510	7,194					
TOTAL FOR PROJ NO. 2026CPT.01.15.20581												405	346	12	16	133,720	83,575	405				
														28		217,295						
2026CPT.01.15.20582	Martin	10	SR-1117 / GREEN ACRES RD	FROM SR 1114 (DAN PEELE RD) TO SR 1115 (WHITE RD.)	3	2	2WU	1.1	20	0	1.1					11,616	7,260					
2026CPT.01.15.20582	Martin	11	SR-1120 / HICKORY GROVE RD	FROM SR 1117 (BEAR TRAP RD) TO SR 1119 (RAPH TAYLOR RD)	3	2	2WU	0.99	19	0	0.99					10,454	10,454					
2026CPT.01.15.20582	Martin	12	SR-1189 / RAWLS RD	FROM SR 1159 (THIRD ST) TO US 64 ALT	3	2	2WU	0.27	21	0	0.27					2,851	1,782					
2026CPT.01.15.20582	Martin	13	SR-1321 / HINES RD	FROM NC 125 TO SR 1002 (HASSEL RD)	3	2	2WU	0.75	20	0	0.75					7,920	4,950					
2026CPT.01.15.20582	Martin	14	SR-1540 / SIM DANIEL RD	FROM NC 171 TO SR 1539 (EVAN PERRY RD)	3	2	2WU	0.57	21	0	0.57					6,019	3,762					
2026CPT.01.15.20582	Martin	15	SR-1601 / BREEZE WOODS AVE	FROM SR 1501 (BIG MILL RD) TO CDS	3	2	2WU	0.21	19	0	0.21					38,860	28,208					
TOTAL FOR PROJ NO. 2026CPT.01.15.20582												389	*			67,068						
GRAND TOTAL												16,642				405	346	12	16	172,580	111,783	405
															28		284,363					

NOTES: Less than 5' - 10' undisturbed buffer from ROW, ditchline, water feature, or drainage inlet, add BMP.

BMP Options: Wattle or Silt Fence

EROSION CONTROL DETAIL

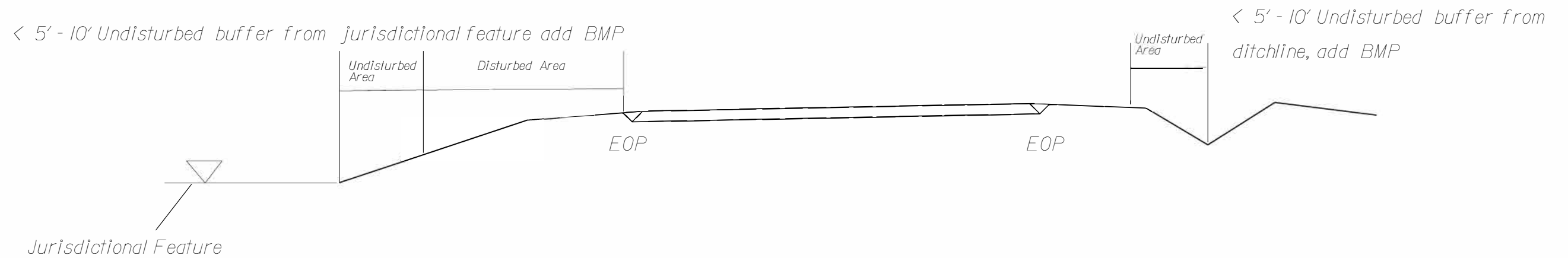
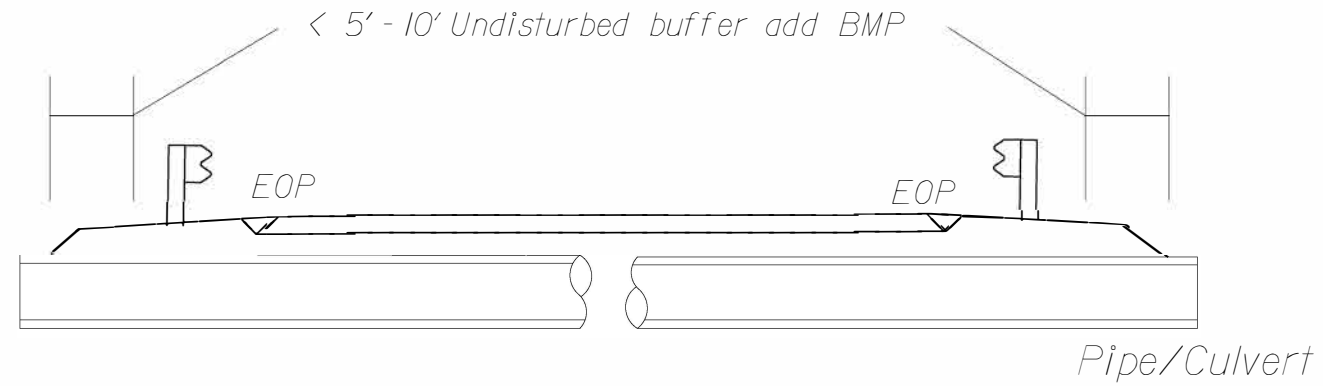

Use BMP's if shoulders and/or frontslopes and/or ditchline and/or backslopes are disturbed

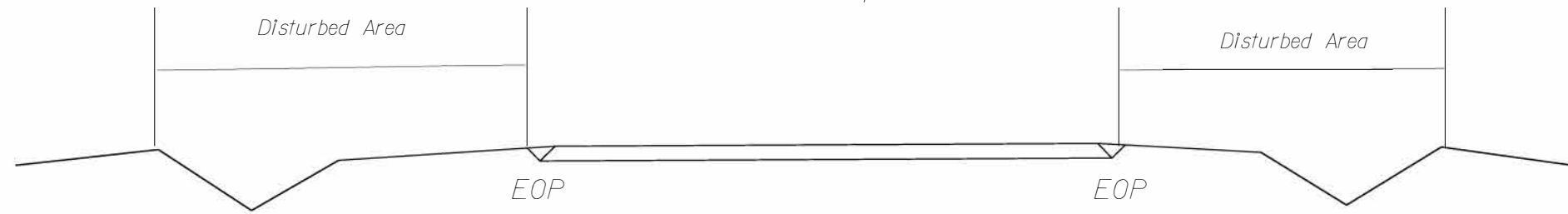

< 5' - 10' Undisturbed buffer from inlet, add wattle

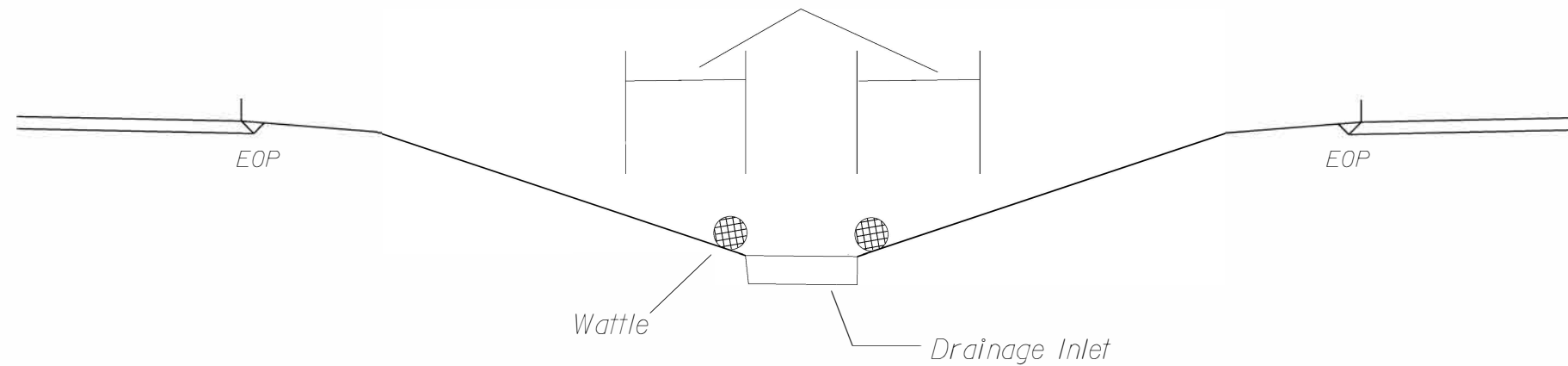

NOT TO SCALE

DIVISION OF HIGHWAYS
STATE OF NORTH CAROLINA

SOIL STABILIZATION TIMEFRAMES

SITE DESCRIPTION	STABILIZATION TIME	TIMEFRAME EXCEPTIONS
PERIMETER DIKES, SWALES, DITCHES AND SLOPES	7 DAYS	NONE
HIGH QUALITY WATER (HQW) ZONES	7 DAYS	NONE
SLOPES STEEPER THAN 3:1	7 DAYS	IF SLOPES ARE 10' OR LESS IN LENGTH AND ARE NOT STEEPER THAN 2:1, 14 DAYS ARE ALLOWED.
SLOPES 3:1 OR FLATTER	14 DAYS	7 DAYS FOR SLOPES GREATER THAN 50' IN LENGTH.
ALL OTHER AREAS WITH SLOPES FLATTER THAN 4:1	14 DAYS	NONE, EXCEPT FOR PERIMETERS AND HQW ZONES.

SIGNING FOR RESURFACING PROJECTS

LEGEND
 ┆ STATIONARY SIGN
 ← DIRECTION OF TRAFFIC FLOW

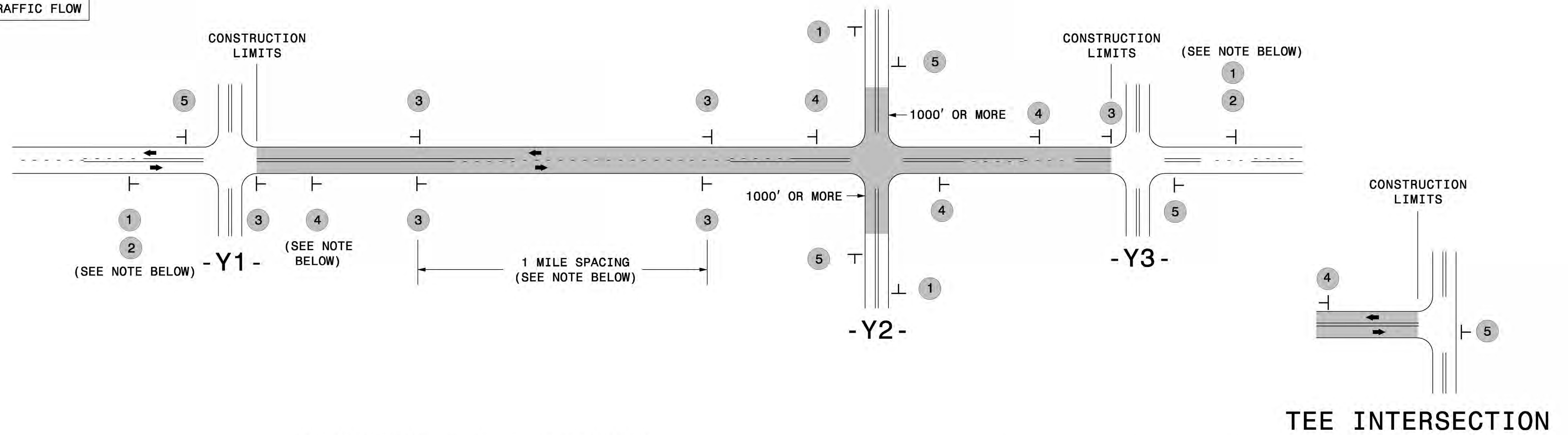

MAINLINE (-L-) SIGNING

-Y- LINE SIGNING

SIGNING NOTES AND PLACEMENT PER DIRECTION	1		PLACE 1000' PRIOR TO BEGINNING OF CONSTRUCTION LIMITS. ONLY USED ON -Y- LINES IF RESURFACING LIMITS EXTEND 1000' ALONG -Y- LINE.	<p>NO REQUIRED STATIONARY SIGNING FOR THE FOLLOWING -Y- LINE CONDITIONS:</p> <ol style="list-style-type: none"> 1) LESS THAN 1000' OF RESURFACING ALONG -Y- LINE 2) SUBDIVISION ROADS 3) DEAD END ROADS <p>WHEN PAVING/CONSTRUCTION ACTIVITIES PROCEED ACROSS AN UNSIGNED -Y- LINE, PORTABLE ADVANCE WARNING SIGNS SHALL BE USED ALONG THE -Y- LINE AS SHOWN BELOW. REMOVE UPON COMPLETION OF WORK.</p> <div style="display: flex; justify-content: space-around;"> <div style="text-align: center;"> W20-1 48" X 48" PLACED 500' IN ADVANCE OF FLAGGER. </div> <div style="text-align: center;"> W20-7 A 48" X 48" PLACED 250' IN ADVANCE OF FLAGGER. </div> </div>
	2		#2 SIGN ONLY USED WHEN CONSTRUCTION LIMITS ARE 2 OR MORE MILES IN LENGTH. ROUND UP TO NEXT WHOLE NUMBER. (NO FRACTIONAL OR DECIMAL NUMBERS)	
	3		- PLACE INITIALLY AT THE CONSTRUCTION LIMITS AND SPACE 1 MILE APART THEREAFTER. - AT TEE INTERSECTIONS INSTALL INITIALLY 1/2 MILE FROM INTERSECTION AND SPACE 1 MILE APART THEREAFTER.	
	4		- THESE ARE FOR -Y- LINES THAT ARE "THROUGH" ROADWAYS. - DEAD END AND SUBDIVISION ROADS ARE NOT "THROUGH" ROADWAYS. - INSTALL 500' +/- FROM EACH -Y- LINE APPROACH AS SHOWN ABOVE. - FOR MULTIPLE -Y- LINES THAT ARE SEPARATED BY 0.25 MILES OR LESS, TREAT AS A SINGLE UNIT AND INSTALL WITHIN 500' OF EACH APPROACH. - A MAXIMUM OF 2 SIGN SETS PER MILE. DO NOT INSTALL WHEN -Y- LINES ARE WITHIN 0.5 MILES FROM "END ROAD WORK" SIGN. - FOR TEE INTERSECTIONS, INSTALL WITHIN 500' +/- OF THE INTERSECTION ALONG -L- LINE.	
	5		PLACE 500' FOLLOWING THE END OF CONSTRUCTION LIMITS OR AS SHOWN WHEN WORK ENDS AT A 3-WAY TEE INTERSECTION.	

THE ABOVE SIGNS ARE ALL THAT ARE REQUIRED FOR A CONTRACTOR TO BEGIN A RESURFACING CONTRACT. ANY ADDITIONAL SIGNS REQUESTED BY NCDOT DIVISIONS SHALL BE INSTALLED WITHIN 7 BUSINESS DAYS OF THE START OF CONTRACT WORK.

MAPS LESS THAN 2 MILES

FOR RESURFACING MAPS WITH CONSTRUCTION LIMITS LESS THAN 2 MILES IN LENGTH, NO STATIONARY SIGNS ARE REQUIRED. USE PORTABLE "ROAD UNDER CONSTRUCTION" OR "ROAD WORK AHEAD" SIGNS IN LIEU OF STATIONARY ADVANCE WARNINGS SIGNS.

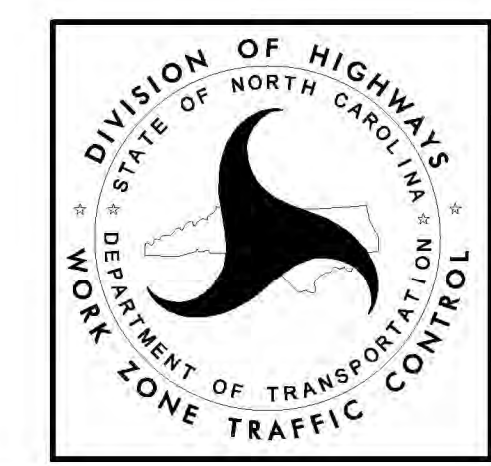

ADVANCE WARNING SIGNS FOR RURAL AND SUBURBAN 2-LANE ROADWAY RESURFACING

5/15/2017 5:11:10 PM \\NCDOT\GIS\Resurfacing\2L2W & AST_Resurfacing_Details\Resurfacing_AdvWarn_2Ln.dgn User:keads